

NORTHSIDE ESTATE - STAGE 1 BUILDING ENVELOPES

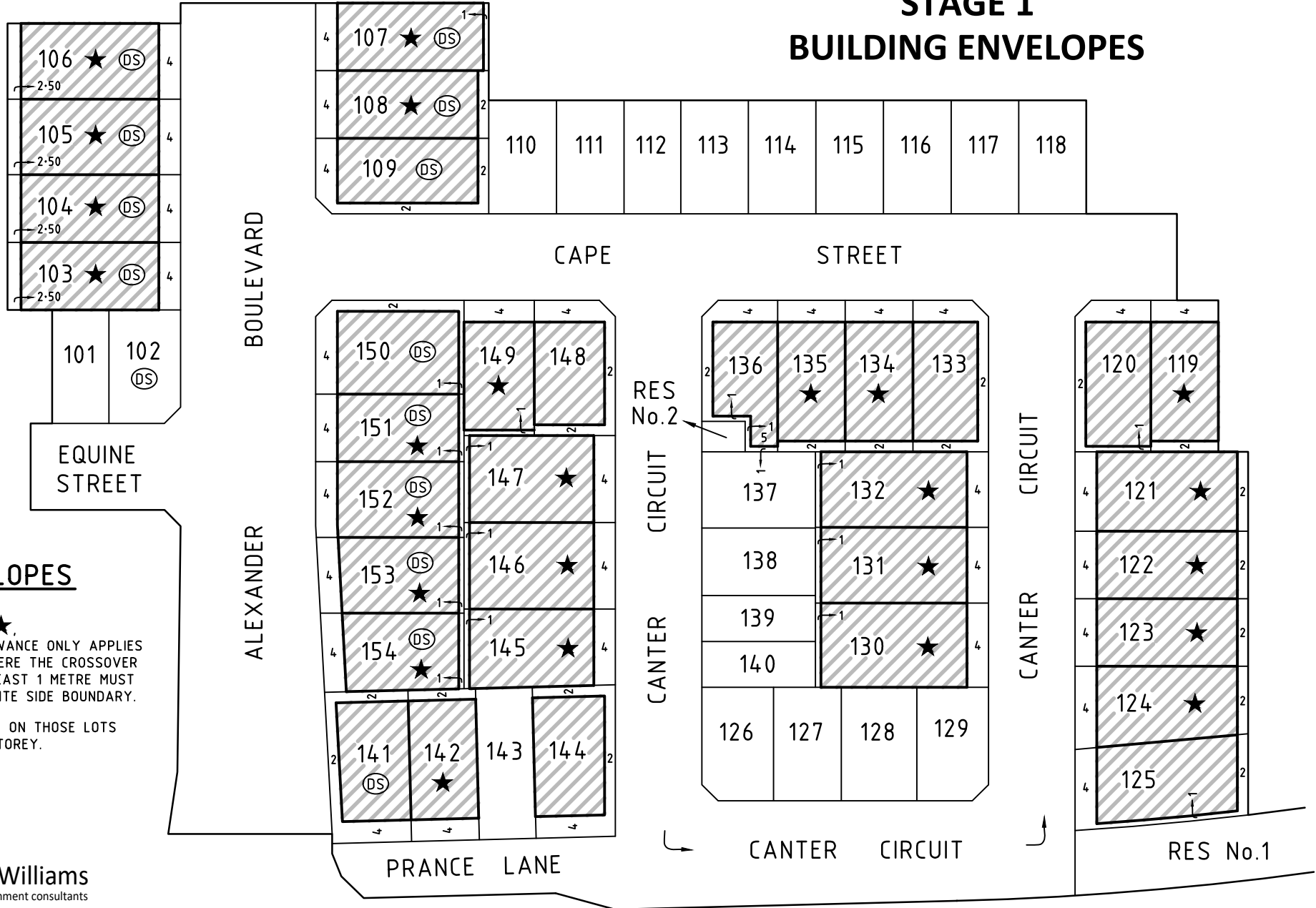
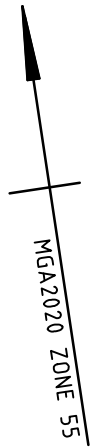

BUILDING ENVELOPES

SIDE SETBACKS
 FOR LOTS IDENTIFIED THUS: ★,
 A BUILD TO BOUNDARY ALLOWANCE ONLY APPLIES
 TO THE SIDE OF THE LOT WHERE THE CROSSOVER
 EXISTS. A SETBACK OF AT LEAST 1 METRE MUST
 BE PROVIDED FOR THE OPPOSITE SIDE BOUNDARY.

ⓁS DENOTES DWELLINGS ON THOSE LOTS
 MUST BE DOUBLE STOREY.